

- ATENȚIE !**
- SE RECOMANDA CA EXCAVAȚIILE GROSIERE SA SE EXECUTE IN RITM ALERT, PE CAT POSSIBIL INTR-O PERIOADA LIPSA DE PRECIPITATII, IAR LUCRARILE SA FIE SUPRAVEGHEATE DE GEOTEHNICIAN;
 - ULTIMUL STRAT DE PE FUNDUL SAPATURII (CIRCA 20 CM) VA FI INDEPARTAT INAINTE DE TURNAREA STRAJII II DE EGALIZARE DIN BETON SIMPLU.

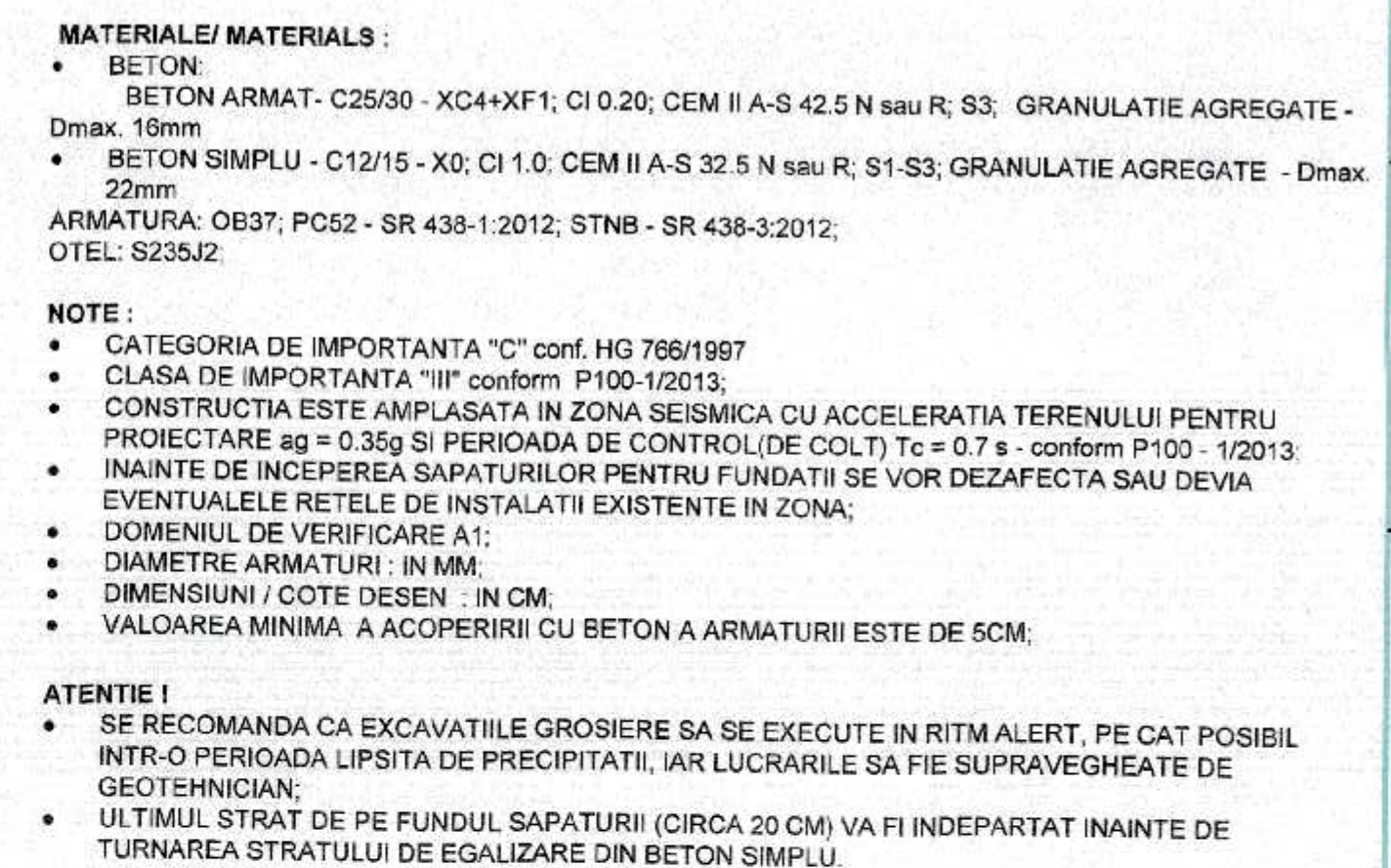

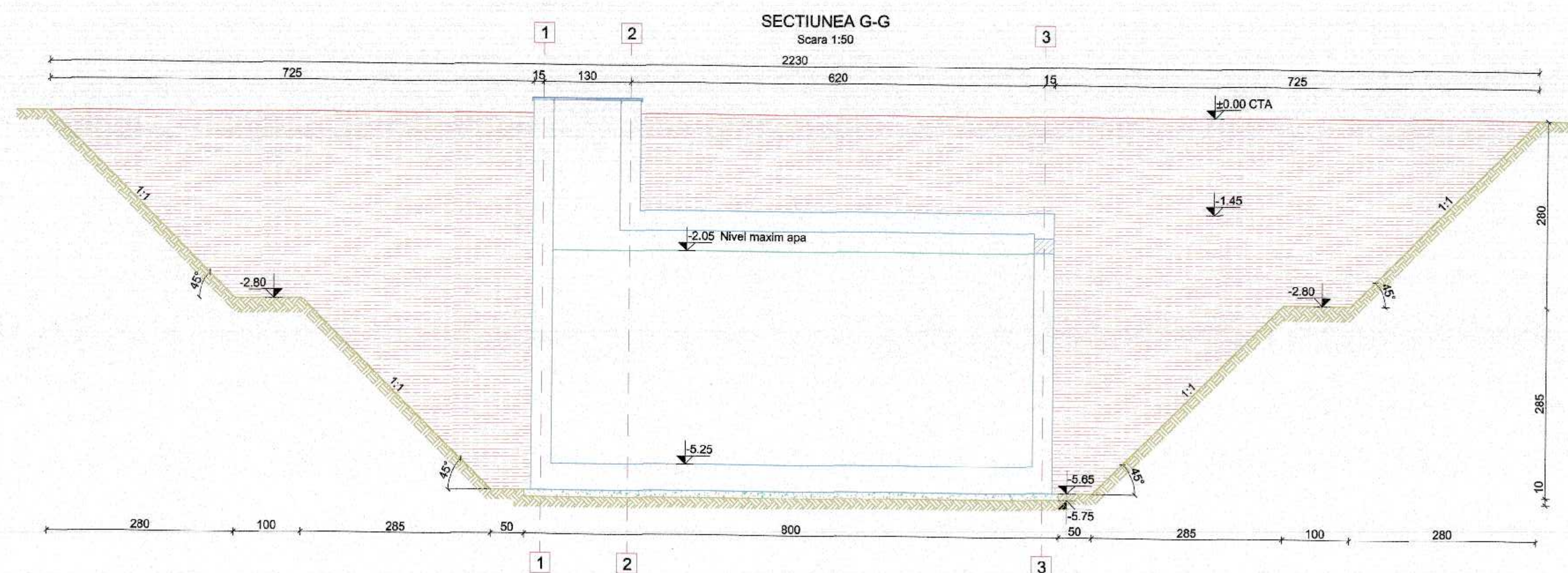

04																			
03																			
01	04.2019	Emis pentru construire																	
00	02.2019	Prima revizie																	
REV.	DATA	DESCREREA MODIFICARII																	
		 																	
		SIA ENDOGENIC & CONSULTING SIA ENDOGENIC & CONSULTING Calea 131 Bucuresti, Romania Tel: +40 21 478 659 E-mail: office@endo.ro																	
		CONPET S.A. - BORDUL PISCINEI, STR. ALEI NOI nr. 53 TEL: +40 21 478 659 E-mail: info@conpet.ro																	
		NR. PROIECT 1 2 3 4 5 6 7 8 9 10 11 12 13 14 15 16 NR. PROIECT DESEN NUMAR REV.																	
		B.368.017 CS-PLN-003 01																	
		SPECIALITATE 17 18 19 20 21 22 23																	
		CIVIL FAZA / PT-DE A1.0																	
		DENUMIRE DESEN NUMAR PAGINA																	
		SCARA: 1:50 PLAN SAPATURA BAZIN APE PLUVIALE 2/5																	

Scara / Scale 1:10 cote in mm

Scara / Scale 1:10 cote in mm

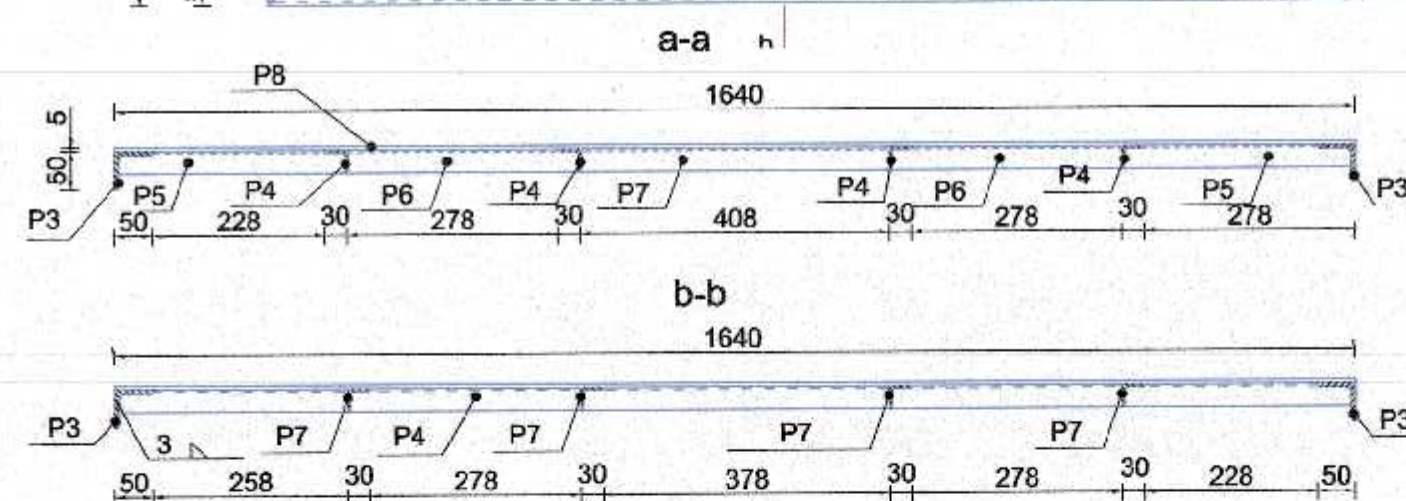

P8: Chequered sheet / Tabla striata 3x1540x1540
Scale/ Scara 1:20
cote in mm

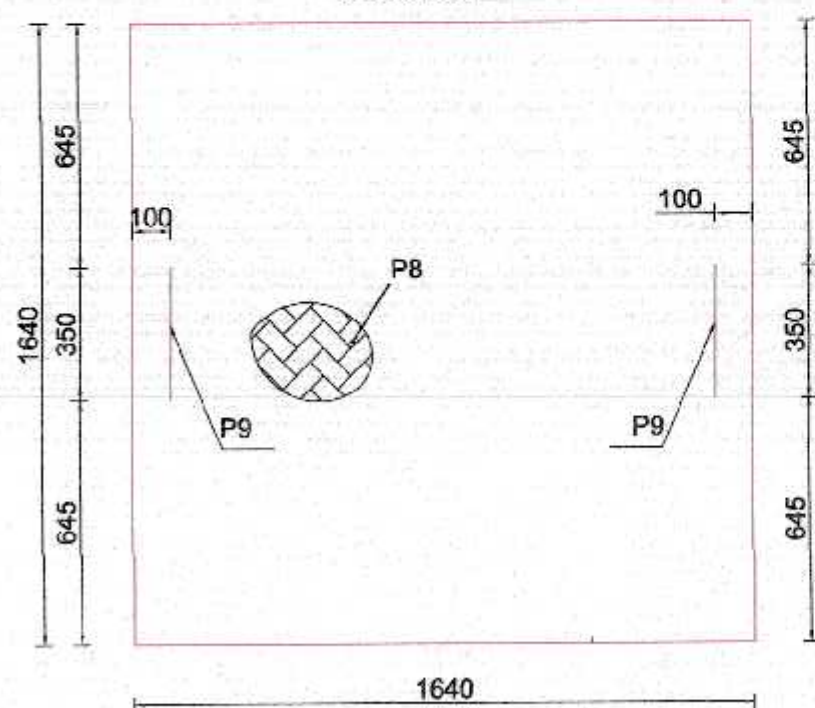

Bill of materials/ Lista de materiale							
Pcs. Poz.	Name / Numo	Material	Product Norm Norma Produs	Pcs. Buc.	Dimensions Dimensiuni	Weight / Greutate kg/pcs	Total
P1	L50x50x5	S235 J2	SR EN 10056-1-2000	4	1100	-	3.77 16.59
P2	Lug/Prazn 48	O837	STAS 438/1	20	240	-	0.46 1.90
P3	L50x50x5	S235 J2	SR EN 10056-1-2000	4	1640	-	3.77 24.73
P4	L30x30x4	S235 J2	SR EN 10056-1-2000	4	1630	-	1.78 11.81
P5	L30x30x4	S235 J2	SR EN 10056-1-2000	8	300	-	1.78 4.27
P6	L30x30x4	S235 J2	SR EN 10056-1-2000	8	305	-	1.78 4.34
P7	L30x30x4	S235 J2	SR EN 10056-1-2000	4	408	-	1.78 9.90
P8	Chequered sheet	S235 J2	STAS 3480-80	1	5 1640	105.57	- 105.57
P9	Maner/lever 1212	PC52	STAS 438/1	2	450	-	0.88 8.00
Total (kg) - including 3% weld							178

P9
Ø12 L=450mm

50 100 150 100

Scara / Scale 1-10

Scara / Scale 1-10

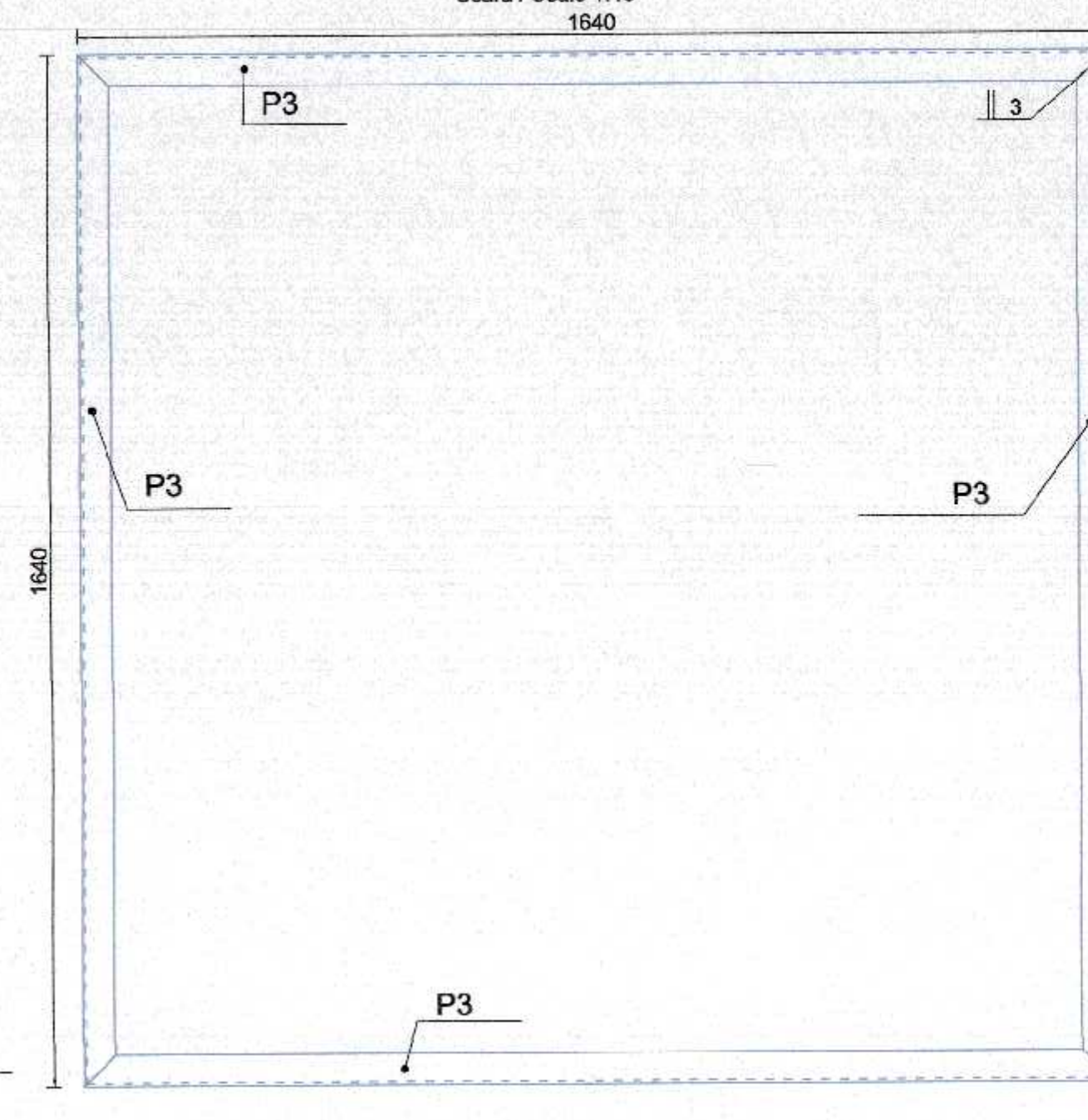

P3: L 50x50x5-1640
1540

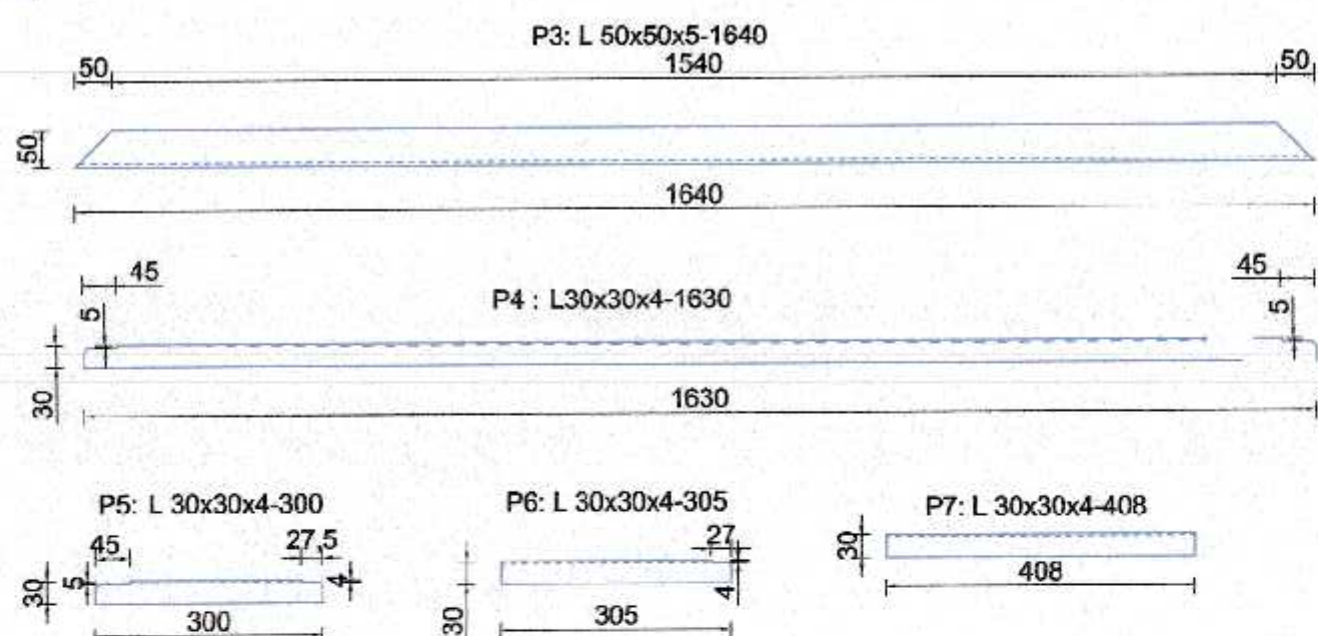

EMBEDDED EQUAL IN CHEPENG WALL / DETALIU CORNIER ÎNGLOEBAT ÎN PERETELE

CHEPENCULUI

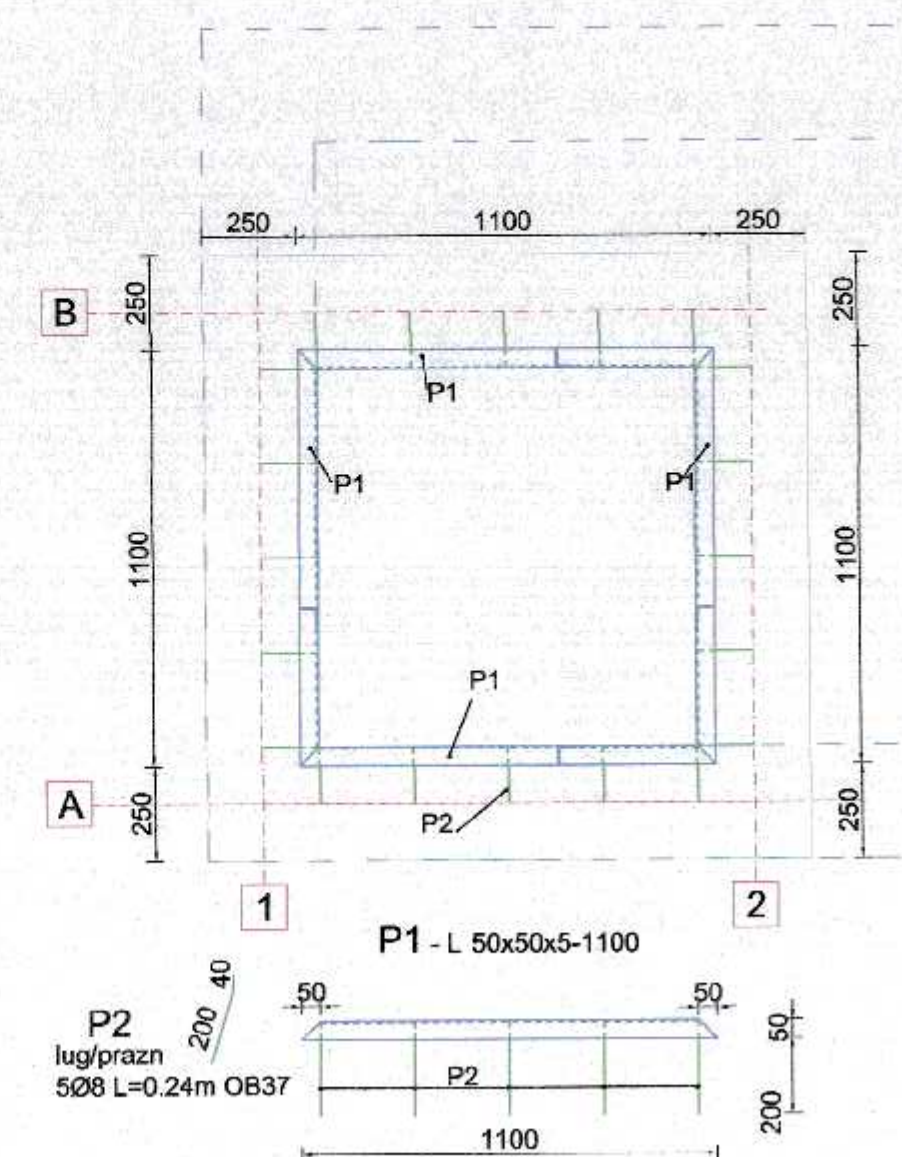

- **BETON:**

- **BETON:**
 BETON ARMAT- C25/30 - XC4+XF1; CI 0.20; CEM II A-S 42.5 N sau R; S3; GRANULATIE AGREGATE - Dmax. 16mm
 - **BETON SIMPLU** - C12/15 - X0; CI 1.0; CEM II A-S 32.5 N sau R; S1-S3; GRANULATIE AGREGATE - Dmax. 22mm
- ARMATURA:** OB37; PC52 - SR 438-1:2012; STNB - SR 438-3:2012;
OTEL: S235J2;

- CATEGORIA DE IMPORTANTA "C" conf. HG 766/1997

- CLASA DE IMPORTANTA "III" conform P100-1/2013;
- CONSTRUCTIA ESTE AMPLASATA IN ZONA SEISMICA CU ACCELERATIA TERENULUI PENTRU PROIECTARE $a_g = 0.35g$ SI PERIOADA DE CONTROL(DE COLT) $T_c = 0.7$ s - conform P100 - 1/2013;
- INAINTE DE INCEPEREA SAPATURILOR PENTRU FUNDATII SE VOR DEZAFECTA SAU DEVIA EVENTUALELE RELETE DE INSTALATII EXISTENTE IN ZONA;
- DOMENIUL DE VERIFICARE A1;
- DIAMETRE ARMATURII : IN MM;
- DIMENSIUNI / COTE DESEN : IN CM;
- VALOAREA MINIMA A ACOPERIRII CU BETON A ARMATURII ESTE DE 5CM;

TOATE STRUCTURILE METALICE VOR FI REALIZATE DIN S 235 J2;
TOATE ELEMENTELE METALICE SE INCADREAZA IN CATEGORIA "B"
DE EXECUTIE (CONF. STAS 767/0-88);

- CLASA DE ACCEPTABILITATE A SUDURILOR ESTE "C" (CONF. C150-99 TABEL 5);
- SUDURILE DE COLT NESPECIFICATE IN DESEN VOR AVEA GROSIMEA 0.7 DIN CEL MAI SUBTIRE ELEMENT IMBINAT IAR LUNGIMEA SUDURII VA FI PE TOATA SUPRAFATA DE CONTACT;
- PROTECTIA ANTICOROZIVA : GRUNDUITA (NUMARUL TOTAL DE STRATURI 2 , AVAND GROSIMEA TOTALA 80µm) SI VOPSITA (NUMARUL DE STRATURI 3-5, AVAND GROSIMEA TOTALA 200µm)
- CLASA DE COROZIVITATE : "C3" CONFORM CU GP 121/2013;
- GRADUL DE PREGATIRE A SUPRAFETELOR : "Sa2.5" , "PSa2.5" CONFORM TABEL 4.2 DIN GP 121/2013.
- SISTEM DE ACOPERIRE CU DURABILITATE MARE (H) > 15 ANI CONFORM SR EN ISO 12944-1.

[illegible]

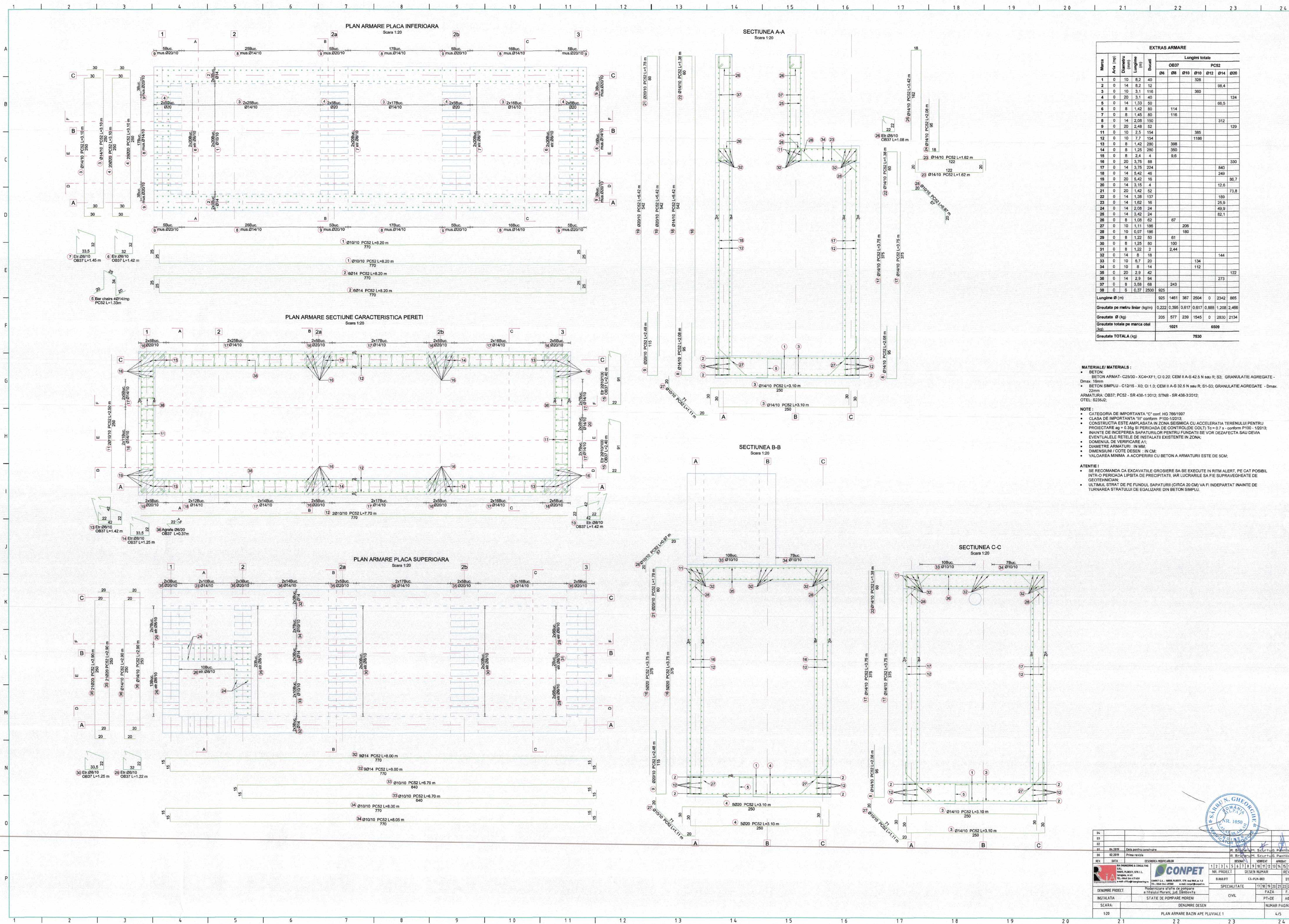

EXTRAS ARMARE											
Marca	Arta (mp)	Diametru (mm)	Lungime (m)	Bucati	Lungimi totale						
					OB37			PC52			
					Ø6	Ø8	Ø10	Ø12	Ø14	Ø20	
1	0	10	8,2	40				328			
2	0	14	8,2	12						98,4	
3	0	10	3,1	116				360			
4	0	20	3,1	40							124
5	0	14	1,33	50						66,5	
6	0	8	1,42	80			114				
7	0	8	1,45	80			116				
8	0	14	2,08	150						312	
9	0	20	2,48	52							129
11	0	10	2,5	154				385			
12	0	10	7,7	154				1186			
13	0	8	1,42	290			398				
14	0	8	1,25	290			350				
15	0	8	2,4	4			9,6				
16	0	20	3,75	88						330	
17	0	14	3,75	224						840	
18	0	14	5,42	46						249	
19	0	20	5,42	16							86,7
20	0	14	3,15	4						12,6	
21	0	20	1,42	52							73,8
22	0	14	1,38	137						189	
23	0	14	1,62	16						25,6	
24	0	14	2,08	24						49,9	
25	0	14	3,42	24						82,1	
26	0	8	1,08	62			67				
27	0	10	1,11	186				206			
28	0	10	0,97	186				180			
29	0	8	1,22	50			61				
30	0	8	1,25	80			100				
31	0	8	1,22	2			2,44				
32	0	14	8	18						144	
33	0	10	8,7	20					134		
34	0	10	8	14					112		
35	0	20	2,9	42							122
36	0	14	2,9	94						273	
37	0	8	3,58	68			243				
38	0	8	0,37	2500	925						
Lungime Ø (m)					925	1461	387	2504	0	2342	865
Greutate pe metru linar (kg/m)					0,222	0,385	0,617	0,617	0,883	1,208	2,486
Greutate Ø (kg)					205	577	239	1545	0	2830	2134
Greutate totala pe marca oțel (kg)						1021			6509		
Greutate TOTALA (kg)									7530		

MATERIALE / MATERIALS :

- BETON
- BETON ARMAT - C25/30 - XC4+XF1; Cl 0,20; CEM II A-S 42,5 N sau R; S3; GRANULATIE AGREGATE - Dmax 16mm
- BETON SIMPLU - C12/15 - X0; Cl 1,0; CEM II A-S 32,5 N sau R; S1-S3; GRANULATIE AGREGATE - Dmax 22mm
- ARMATURA: OB37; PC52 - SR 438-1-2012; STNB - SR 438-3-2012; OTEL: S235J2;

NOTE :

- CATEGORIA DE IMPORTANTA "C" conf. HG 766/1997
- CLASA DE IMPORTANTA "I" conform P100-1/2013.
- CONSTRUCTIA ESTE AMPLASATA IN ZONA SEISMICA CU ACCELERATIA TERENULUI PENTRU PROIECTARE ag = 0,35g SI PERIODA DE CONTROL (DE COLT) Tc = 0,7 s - conform P100 - 1/2013;
- INANT DE INCERPEREA SAPATURILOR PENTRU FUNDATII SE VOR DEZAFECTA SAU DEVA EVENTUALE RELE DE INSTALATII EXISTENTE IN ZONA;
- DOMENIUL DE VERIFICARE A1;
- DIAMETRE ARMATURILOR IN MM;
- DIMENSIUNI / COTE DESEN - IN CM;
- VALOAREA MINIMA A ACOPERIRII CU BETON A ARMATURII ESTE DE 5CM;

ATENTIE !

- SE RECOMANDA CA EXCAVATIILE GROSIERE SA SE EXECUTE IN RITM ALERT, PE CAT POSIBIL INTR-O PERIODA LIPSITA DE PRECIPITATII, IAR LUCRARILE SA FIE SUPRAVEGHEATE DE GEOTEHNICIAN;
- ULTIMUL STRAT DE PE FUNDUL SAPATURII (CIRCA 20 CM) VA FI INDEPARTAT INANT DE TURNAREA STRATULUI DE EGALIZARE DIN BETON SIMPLU.

24

23

22

21

20

19

18

17

16

15

14

13

12

11

10

9

8

7

6

5

4

3

2

1

24

23

22

21

20

19

18

17

16

15

14

13

12

11

10

9

8

7

6

5

4

3

2

1

24

23

22

21

20

19

18

17

16

15

14

13

12

11

10

9

8

7

6

5

4

3

2

1

24

23

22

21

20

19

18

17

16

15

14

13

12

11

10

9

8

7

6

5

4

3

2

1

24

23

22

21

20

19

18

17

16

15

14

13

12

11

10

9

8

7

6

5

4

3

2

1

24

23

22

21

20

19

18

17

16

15

14

13

12

11

10

9

8

7

6

5

4

3

2

1

24

23

22

21

20

19

18

17

16

15

14

13

12

11

10

9

8

7

6

5

4

3

2

1

24

23

22

21

20

19

18

17

16

15

14

13

12

11

10

9

8

7

6

5

4

3

2

1

24

23

22

21

20

19

18

17

16

15

14

13

12

11

10

9

8

7

6

5

4

3

2

1

24

23

22

21

20

19

18

17

16

15

14

13

12

11

10

9

8

7

6

5

4

3

2

1

24

23

22

21

20

19

18

17

16

15

14

13

12

11

10

9

8

7

6

5

4

3

2

1

24

23

22

21

20

19

18

17

16

15

14

13

12

11

10

9

8

7

6

5

4

3

2

1

24

23

22

21

20

19

18

17

16

15

14

13

12

11

10

9

8

7

6

5

4

3

2

1

24

23

22

21

20

19

18

17

16

15

14

13

12

11

10

9

8

7

6

5

4

3

2

1

24

23

22

21

20

19

18

17

16

15

14

13

12

11

10

9

8

7

6

5

4

3

2

1

24

23

22

21

20

19

18

17

16

15

14

13

12

11

10

9

8

7

6

5

4

3

2

1

24

23

22

21

20

19

18

17

16

15

14

13

12

11

10

9

8

7

6

5

4

3

2

1

24

23

22

21

20

19

18

17

16

15

14

13

12

11

10

9

8

7

6

5

4

3

2

1

24

23

22

21

20

19

18

17

16

15

14

13

12

11

10

9

8

7

6

5

4

3

2

1

24

23

22

21

20

19

18

17

16

15

14

13

12

11

10

9

8

7

6

5

4

3

2

1

24

23

22

21

20

19

18

17

16

15

14

13

12

11

10

9

8

7

6

5

4

3

2

1

24

23

22

21

20

19

18

17

16

15

14

13

12

11

10

9

8

7

6

5

4

3

2

1

24

23

22

21

20

19

18

17

16

15

14

13

12

11

10

9

8

7

6

5

4

3

2

1

24

23

22

21

20

19

18

17

16

15

14

13

12

11

10

9

8

7

6

5

4

3

2

1

24

23

22

21

20

19

18

17

16

15

14

13

12

11

10

9

8

7

6

5

4

3

2

1

24

23

22

21

20

19

18

17

16

15

14

13

12

11

10

9

8

7

6

5

4

3

2

1

24

23

22

21

20

19

18

17

16

15

14

13

12

11

10

9

8

7

6

5

4

3

2

1

24

23

22

21

20

19

18

17

16

15

14

13

12

11

10

9

8

7

6

5

4

3

2

1

24

23

22

21

20

19

18

17

16

15

14

13

12

11

10

9

8

7

6

5

4

3

2

1

24

23

22

21

20

19

18

17

16

15

14

13

12

11

10

9

8

7

6

5

4

3

2

1

24

23

22

21

20

19

18

17

16

15

14

13

12

11

10

9

8

7

6

5

4

3

2

1

24

23

22

21

20

19

18

17

16

15

14

13

12

11

10

9

8

7

6

5

4

3

2

1

24

23

22

21

20

19

18

17

16

15

14

13

12

11

10

9

8

7

6

5

4

3

2

1

24

23

22

21

20

19

18

17

16

15

14

13

12

11

10

9

8

7

6

5

4

3

2

1

24

23

22

21

20

19

18

17

16

15

14

13

12

11

10

9

8

7

6

5

4

3

2

1

24

23

22

21

20

19

18

17

16

15

14

13

12

11

10

9

8

7

6

5

4

3

2

1

24

23

22

21

20

19

18

17

16

15

14

13

12

11

10

9

8

7

6

5

4

3

2

1

24

23

22

21

20

19

18

17

16

15

14

13

12

11

10

9

8

7

6

5

4

3

2

1

24

23

22

21

20

19

18

17

16

15

14

13

12

11

10

9

8

7

6

5

4

3

2

1

24

23

22

21

20

19

18

17

16

15

14

13

12

11

10

9

8

7

6

5

4

3

2

1

24

23

22

21

20

19

18

17

16

15

14

13

12

11

10

9

8

7

6

5

4

3

2

1

24

23

22

21

20

19

18

17

16

15

14

13

12

11

10

9

8

7

6

5

4

3

2

1

24

23

22

21

20

19

18

17

16

15

14

13

12

11

10

9

8

7

6

5

4

3

2

1

24

23

22

21

20

19

18

17

16

15

14

13

12

11

10

9

8

7

6

5

4

3

2

1

24

23

22

21

20

19

18

17

16

15

14

13

12

11

10

9

8

7

6

5

4

3

2

1

24

23

22

21

20

19

18

17

16

15

14

13

12

11

10

9

8

7

6

5

4

3

2

1

24

23

22

21

20

19

18

17

16

15

14

13

12

11

10

9

8

7

6

5

4

3

2

1

24

23

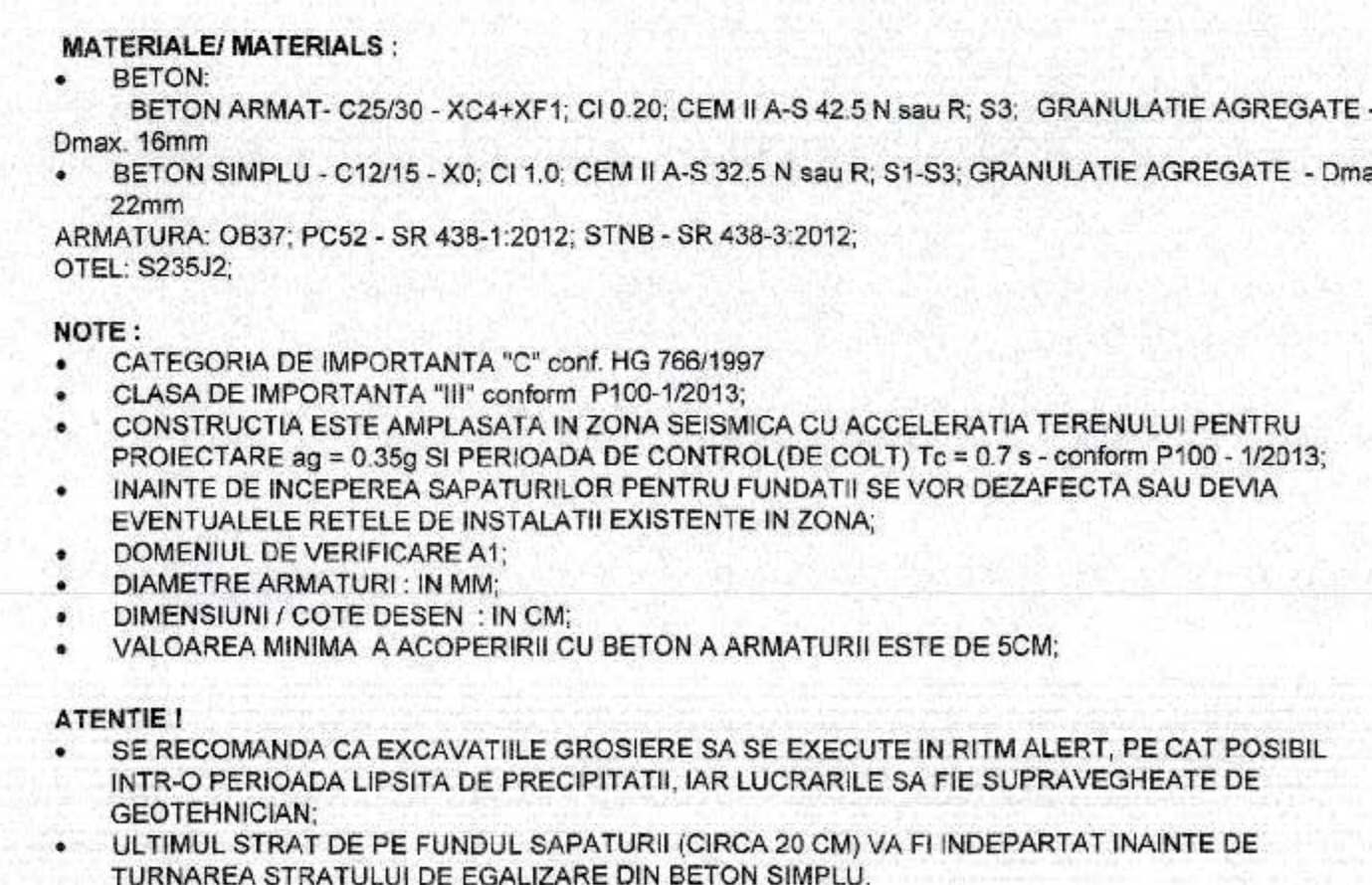
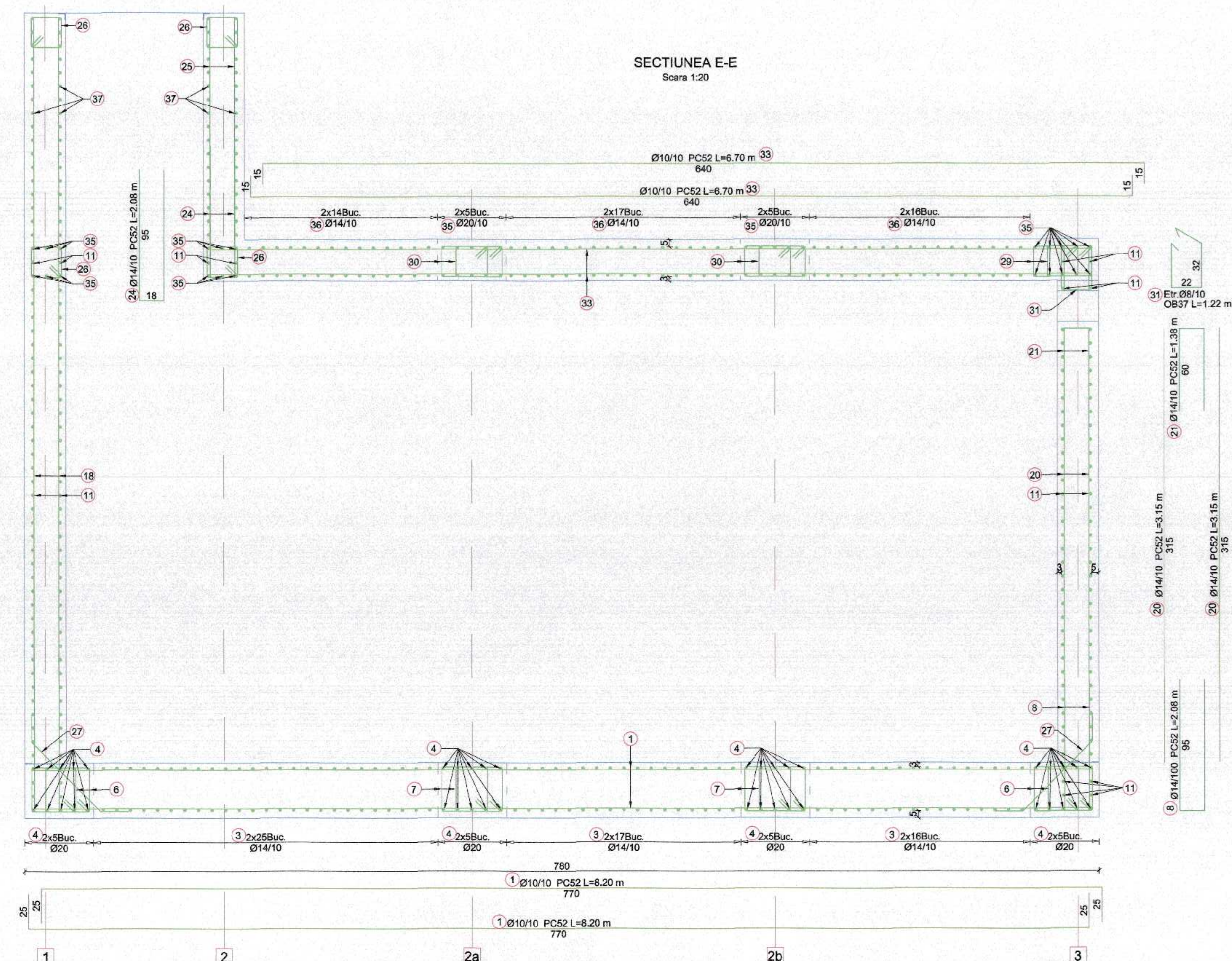
[illegible]